

TRAFFIC CONTROL - GENERAL NOTES

1. ONLY MAJOR STAGES OF CONSTRUCTION ARE SHOWN IN THE STAGING AND TRAFFIC CONTROL PLAN. THE CONTRACTOR SHALL SUBMIT A WORK SCHEDULE AT THE PRE-CONSTRUCTION MEETING CONTAINING TARGET DATES FOR CRITICAL ITEMS AND ESTIMATED DATES FOR THE VARIOUS TRAFFIC CONTROL STAGING. THE CONTRACTOR IS RESPONSIBLE FOR PROVIDING DETAILED TRAFFIC CONTROL PLANS FOR ANY OTHER STAGES THAT MAY BE REQUIRED. CHANGES TO STAGING PLAN MUST BE APPROVED BY ENGINEER.
2. CONTRACTOR IS RESPONSIBLE FOR ALL TRAFFIC CONTROL AND WORK SITE SAFETY. TRAFFIC CONTROL ON THIS PROJECT SHALL BE IN ACCORDANCE WITH SPECIFIC LAYOUTS SHOWN ON THESE PLANS, OR THE IOWA DOT STANDARD ROAD PLANS TC SERIES DETAILS REFERENCED FOR OTHER MINOR OR INCIDENTAL WORK THAT DOES NOT SPECIFICALLY FALL WITHIN THE TRAFFIC CONTROL STAGING DETAIL PROVIDED. TRAFFIC CONTROL DEVICES, PROCEDURES, AND LAYOUTS SHALL BE PER THE MANUAL ON UNIFORM TRAFFIC CONTROL DEVICES FOR STREETS AND HIGHWAYS, AS ADOPTED BY THE DEPARTMENT PER 761 OF THE IOWA ADMINISTRATIVE CODE (IAC), CHAPTER 130.
3. ALL TRAFFIC CONTROL DEVICES SHALL BE FURNISHED, ERECTED, MAINTAINED AND REMOVED BY THE CONTRACTOR. REMOVAL OF TEMPORARY TRAFFIC CONTROL DEVICES SHALL BE INCIDENTAL TO THE TRAFFIC CONTROL PAY ITEM. EXISTING ROADWAY SIGNS WHOSE MESSAGE CONFLICTS WITH PROJECT SIGNING SHALL BE COVERED FOR THE DURATION OF THE CONFLICT (INCIDENTAL TO TRAFFIC CONTROL).
4. ALL TEMPORARY PAVEMENT MARKINGS AND TEMPORARY SYMBOLS SHALL BE REMOVABLE MARKING TAPE. ALL PERMANENT SIGNING AND STRIPING SHALL BE PLACED BEFORE ROADWAYS ARE OPEN TO TRAFFIC, UNLESS OTHERWISE NOTED.
5. THE CONTRACTOR SHALL MAINTAIN ACCESS TO PROPERTIES AT ALL TIMES.
6. CONTRACTOR SHALL ADD "ROAD WORK AHEAD" SIGNS ON ALL ROADS THAT INTERSECT THE PROJECT. PLACEMENT SHALL CONFORM TO IOWA DOT STANDARD ROAD PLANS TC SERIES.
7. THE CONTRACTOR SHALL PROVIDE WRITTEN NOTICE TO THE CITY OF NORTH LIBERTY AT LEAST 1 WEEK IN ADVANCE OF INITIATING TRAFFIC CONTROL STAGING AND SUBSEQUENT TRANSITIONS BETWEEN STAGES. THE CITY WILL ISSUE PUBLIC NOTICES REGARDING THE CHANGES IN TRAFFIC CONTROL.
8. THE SPACING OF ALL SIGNS AND THE DISTANCE BETWEEN SIGNS SHOWN IN THIS PLAN SHALL MEET THE REQUIREMENTS OF THE MANUAL ON UNIFORM TRAFFIC CONTROL DEVICES FOR STREETS AND HIGHWAYS, AS ADOPTED BY THE DEPARTMENT PER 761 OF THE IOWA ADMINISTRATIVE CODE (IAC), CHAPTER 130 AND THE IOWA DOT STANDARD ROAD PLANS TC SERIES. IF THE MINIMUM SPACING BETWEEN SIGNS CANNOT BE MAINTAINED, THE SIGN LOCATIONS SHALL BE ADJUSTED TO PROVIDE THE LARGEST SPACING AVAILABLE.
9. PHASE 1 AND 2 WORK MAY BE COMPLETED CONCURRENTLY OR SUB-PHASED AS NEEDED FOR CONSTRUCTION EFFICIENCY, PROVIDED THAT ALL CRITERIA AND RESTRICTIONS PERTAINING TO ALLOWING A MEANS OF PROPERTY ACCESS ARE MET. CLOSURE DURATION FOR PHASE 1 AREA TO BE MINIMIZED.
10. REFER TO SHEET J.02 AND J.03 FOR DETOUR AND DUST CONTROL NOTES.
11. ALL TYPE III BARRICADES TO HAVE TWO (2) FLASHING BEACONS.
12. CONTRACTOR TO COORDINATE TRAFFIC CONTROL WITH IOWA DOT I-380 AT PENN STREET INTERCHANGE PROJECT.

PHASE 1 CRITICAL CLOSURE NOTES

1. PHASE 1 WORK (W PENN STREET AND JAMES AVENUE INTERSECTION) IS CONSIDERED A CRITICAL CLOSURE AND SHALL BE SUBSTANTIALLY COMPLETED AND OPEN TO TRAFFIC WITHIN 40 CALENDAR DAYS OF CLOSURE OF PHASE 1. SUBSTANTIAL COMPLETION OF THE PHASE 1 AREA TO INCLUDE ALL PAVEMENT, JOINT SEALING, GRADING, SUBDRAIN, AND BACKFILL. SEEDING/MATTING, PERMANENT STRIPING, AND PERMANENT SIGNAGE ARE NOT REQUIRED TO BE COMPLETE TO MEET THE REQUIREMENTS OF THE PHASE 1 CRITICAL CLOSURE WORK. TEMPORARY STOP SIGNS MUST BE PLACED IF PERMANENT SIGNS ARE NOT INSTALLED PRIOR TO OPENING PHASE 1 TO TRAFFIC.

P:\Projects\IC\2112202190\Deliverables\Drawings\1_Civil\J.02 - TRAFFIC CONTROL & STAGING.dwg

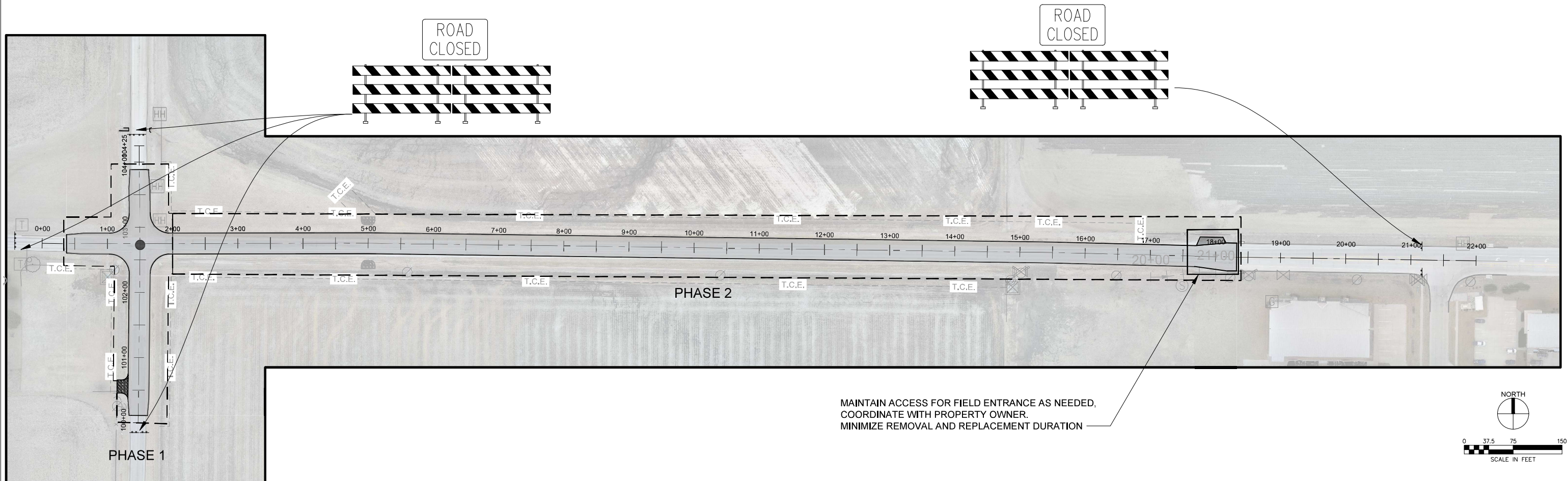

1 WEST PENN STREET PROJECT PHASING
1" = 40'

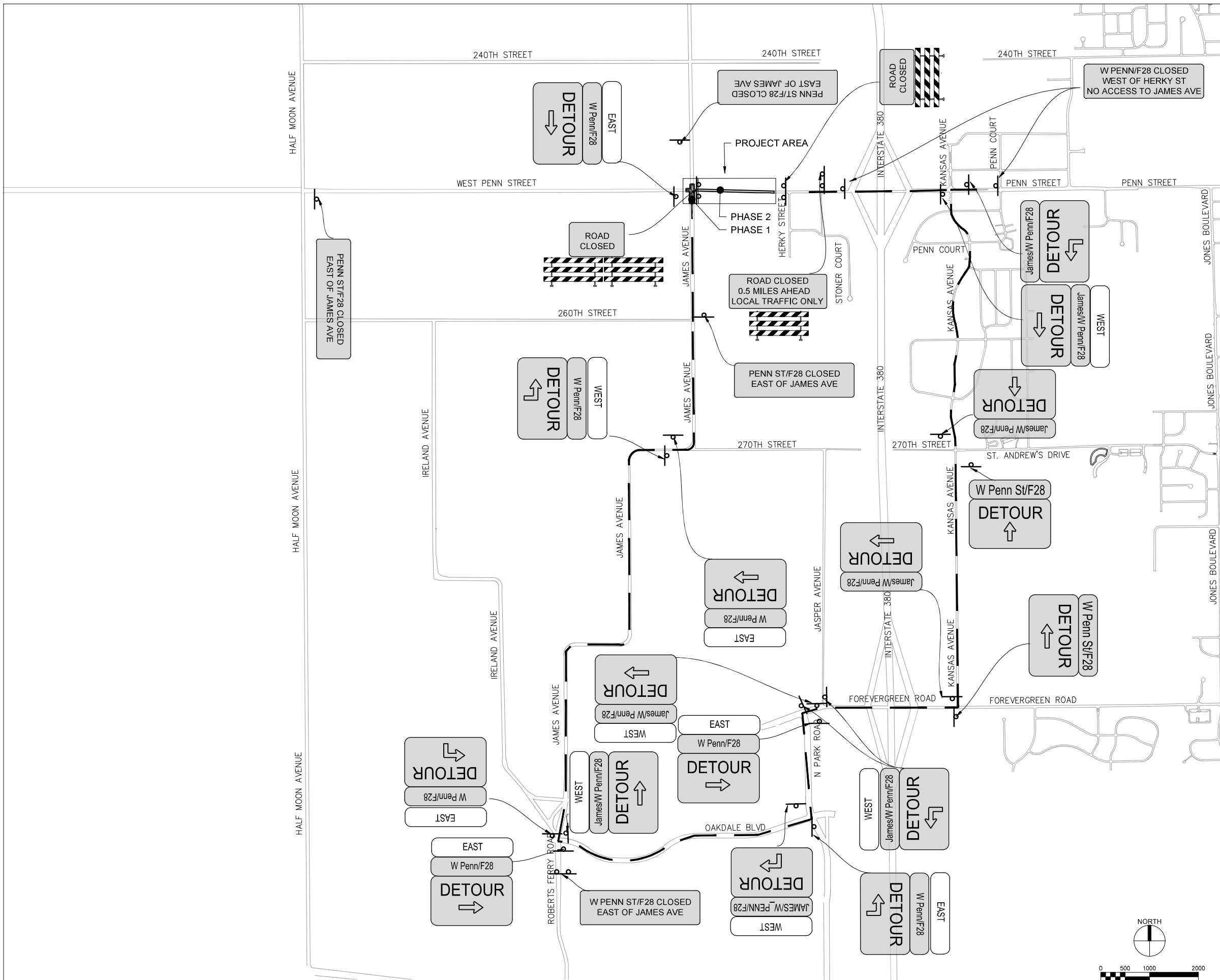

LEGEND	
PLAN MARK	DESCRIPTION
	TRAFFIC CONTROL SIGN (TYPE AS INDICATED)
	DETOUR ROUTE

- DUST CONTROL TREATMENT DETAILS:**
- DUST CONTROL TREATMENTS SHALL USE CALCIUM CHLORIDE DUST PALLIATIVE OF THE FOLLOWING MINIMUM SPECIFICATIONS:
 - SPECIFIC GRAVITY = 1.392
 - RATE OF APPLICATION = 0.21 GALLONS PER SQUARE YARD
 - CONCENTRATION = 38% BY WEIGHT
 - MINIMUM WIDTH OF APPLICATION = 22 FEET
 - SQUARE YARDS OF APPLICATION PER MILE (22 FEET WIDE) = 12,097
 - WEIGHT PER GALLON = 11.58 POUNDS
 - PRODUCT WEIGHT PER APPLICATION = 0.92 POUNDS PER SQUARE YARD.
 - PROVIDE PRODUCT SUBMITTAL AND MSDS FOR DUST PALLIATIVE SUPPLIED. OWNER'S REPRESENTATIVE RESERVES THE RIGHT TO SAMPLE THE MATERIAL AT ANY TIME TO VERIFY MATERIAL COMPLIANCE.
 - APPLICATION EQUIPMENT SHALL BE PRESSURIZED TO ENSURE A CONTROLLED APPLICATION RATE. SIMPLE GRAVITY FEED EQUIPMENT WILL NOT BE ALLOWED. APPLICATION EQUIPMENT SHALL BE EQUIPPED WITH A FLOW METER FOR INSTANT READ OF OUT APPLICATION, AND DISTANCE METER WILL MEASURE IN FEET.
 - APPLICATION EQUIPMENT USED SHALL BE SUCH THAT PROPER AND UNIFORM COVERAGE WITH MINIMAL OVERSPRAY OR WASTE IS OBTAINED OVER THE ENTIRE ROADWAY SURFACE AS DETERMINED BY THE OWNER'S REPRESENTATIVE.

- DETOUR NOTES:**
- ALL VEHICULAR SIGNAGE SHALL CONFORM TO THE STANDARDS IN THE MANUAL ON UNIFORM TRAFFIC CONTROL DEVICES (MUTCD) LATEST EDITION. TRAFFIC CONTROL AND DETOUR SIGNAGE SHALL BE ORANGE WITH BLACK LETTERING.
 - INSTALL "ROAD WORK AHEAD" SIGNAGE PER MUTCD GUIDELINES ALONG PENN STREET AND JAMES AVENUE.
 - ALL SIGNAGE SHALL BE COORDINATED WITH OTHER TRAFFIC CONTROL PLANS IN THE AREA.
 - ALL TRAFFIC CONTROL AND SIGNAGE SHALL BE FURNISHED, ERECTED, MAINTAINED AND REMOVED BY CONTRACTOR UNLESS OTHERWISE NOTED.
 - WORK TO BE COMPLETED IN A MANNER THAT MAINTAINS ACCESS TO PROPERTY OWNER DRIVEWAYS AT ALL TIMES.
 - ALL DRIVEWAY CLOSURES SHALL BE COORDINATED WITH PROPERTY OWNER AND THE CITY REPRESENTATIVE AT A MINIMUM OF 1 WEEK PRIOR.
 - DETOUR ROUTING TO UTILIZE KANSAS AVENUE, FOREVERGREEN ROAD, OAKDALE BLVD, JAMES AVENUE.
 - REFER TO SHEET J.01 FOR ADDITIONAL NOTES.
 - ALL TYPE III BARRICADES TO HAVE TWO (2) FLASHING BEACONS

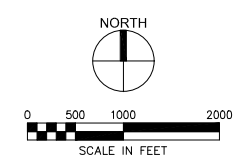

PHASE 2 DETOUR - PHASE 1 (JAMES AVE & W PENN ST INTERSECTION) OPEN TO TRAFFIC

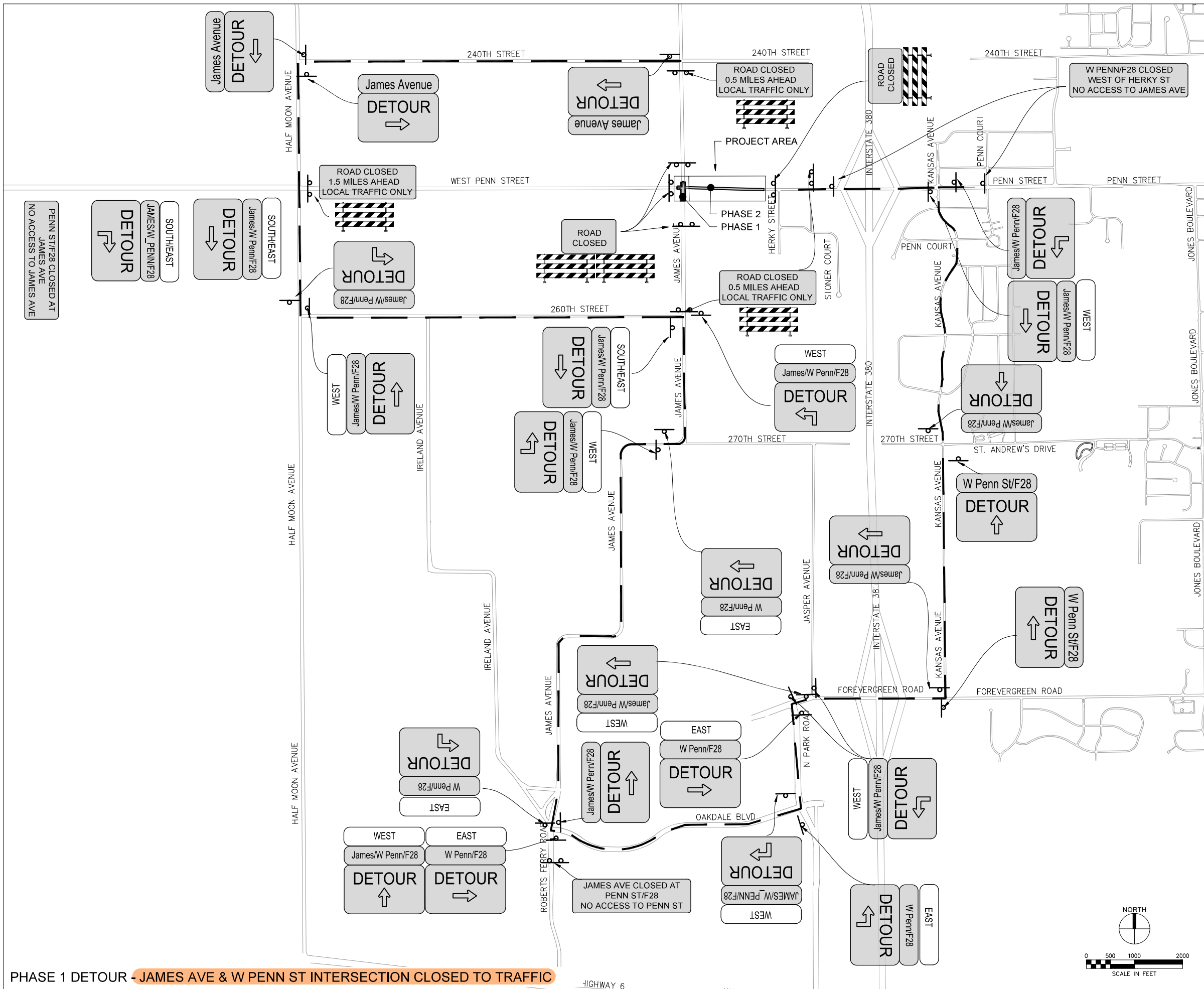

LEGEND	
PLAN MARK	DESCRIPTION
	TRAFFIC CONTROL SIGN (TYPE AS INDICATED)
	DETOUR ROUTE

- DETOUR NOTES:**
1. ALL VEHICULAR SIGNAGE SHALL CONFORM TO THE STANDARDS IN THE MANUAL ON UNIFORM TRAFFIC CONTROL DEVICES (MUTCD) LATEST EDITION. TRAFFIC CONTROL AND DETOUR SIGNAGE SHALL BE ORANGE WITH BLACK LETTERING.
 2. INSTALL "ROAD WORK AHEAD" SIGNAGE PER MUTCD GUIDELINES ALONG PENN STREET AND JAMES AVENUE.
 3. ALL SIGNAGE SHALL BE COORDINATED WITH OTHER TRAFFIC CONTROL PLANS IN THE AREA.
 4. ALL TRAFFIC CONTROL AND SIGNAGE SHALL BE FURNISHED, ERECTED, MAINTAINED AND REMOVED BY CONTRACTOR UNLESS OTHERWISE NOTED.
 5. WORK TO BE COMPLETED IN A MANNER THAT MAINTAINS ACCESS TO PROPERTY OWNER DRIVEWAYS AT ALL TIMES.
 6. ALL DRIVEWAY CLOSURES SHALL BE COORDINATED WITH PROPERTY OWNER AND THE CITY REPRESENTATIVE AT A MINIMUM OF 1 WEEK PRIOR.
 7. DETOUR ROUTING TO UTILIZE KANSAS AVENUE, FOREVERGREEN ROAD, OAKDALE BLVD, JAMES AVENUE, 260TH STREET AND HALF MOON AVENUE.
 8. DUST CONTROL MEASURES TO BE PROVIDED AT GRAVEL INTERSECTIONS AND ADJACENT TO RESIDENCIES OR AS IDENTIFIED BY OWNER'S REPRESENTATIVE.
 9. REFER TO SHEET J.01 FOR ADDITIONAL NOTES.
 10. ALL TYPE III BARRICADES TO HAVE TWO (2) FLASHING BEACONS

PHASE 1 DETOUR - JAMES AVE & W PENN ST INTERSECTION CLOSED TO TRAFFIC